

ICW KIW WORKSURFACE TRAY INSTALLATION

ICWUSA.com, Inc.

If you have any questions please call Toll Free 1-800-558-4435

IF ATTACHING TO DROP EXTENSION

ATTACH FLIP UP

1. Remove screws from drop extension using 5/32" hex key.
2. Align holes in keyboard tray with screw holes in drop extension.
3. Attach keyboard tray using the provided screws.

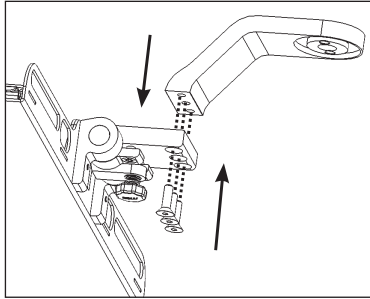

IF ATTACHING TO QUICK DISCONNECT

ATTACH QUICK DISCONNECT

1. Remove beauty cap on quick disconnect block.
2. Remove screw using 3/16" hex key.
3. Slide keyboard tray into quick disconnect block.
4. Replace screw and tighten.
5. Replace beauty cap.

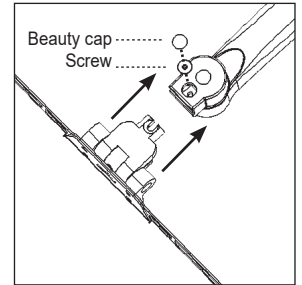

CABLE MANAGEMENT

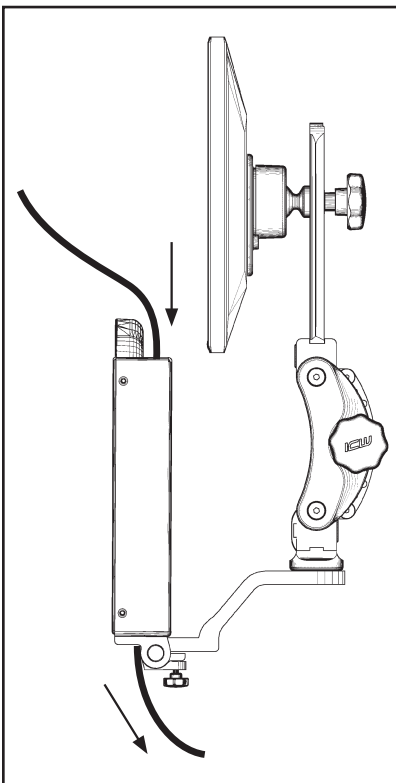

- Flip up WorkSurface tray into vertical position.
- Drop keyboard cable through tray from top.
- Cable should exit from back of tray.
- If necessary, pull out keyboard tray for better access.

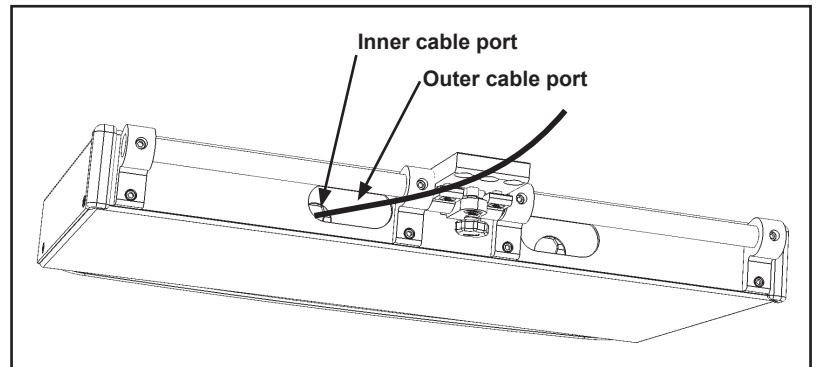

- Thread cable through inner and outer ports in back of WorkSurface tray.
- Store excess cable inside tray.

CLEANING OF THE ICW MOUNTING DEVICE

When cleaning your ICW mounting unit please follow the points below. Proper cleaning of the mounting device will help assure proper function and extend the life of the unit.

1. Any general cleaner is acceptable except degreasers are not recommended near the bearing entrances.
2. Spray cleaner or water on a soft cloth or paper towel and then wipe down the mounts.
3. Do not spray directly at the bearing seams (located at all swivel points) as this could reduce the life of the bearings.

NOTICE: ICWUSA.COM, Inc. provides the appropriate hardware fasteners to match the majority if not all standard monitors and devices. It is the responsibility of the installer / integrator to ensure that the screws and fasteners have the adequate thread engagement. The rule of thumb is that the thread depth is greater than the diameter of the hole or 4 full turns of 360 degrees of thread engagement. It is also the responsibility of the installer / integrator to ensure that they do not damage the monitor or device by using a screw or fastener that is too long for hole and therefore damaging the unit by inserting too far.