

ICW PRO SLIDE UNDERCABINET WORKSTATION INSTALLATION

ICWUSA.com, Inc.

If you have any questions please call Toll Free 1-800-558-4435

► MAXIMUM LOAD CAPACITY: 30 LBS. (13.6 KG)

MOUNT PRO SLIDE TO CABINET UNDERSIDE

To watch the installation video and follow along, click [here](https://youtu.be/3mlAwRwqhkg) or search: <https://youtu.be/3mlAwRwqhkg>

Installation Video Time Stamp: 20 sec.

1) Installer should verify that the installation surface is flat, level, and structurally adequate to support the Pro Slide track/articulating arm assembly.

2) Locate the track towards the back of the cabinet and in the desired position left-right.

NOTE: ICW supplies flat-head screws and low profile furniture nuts for installing the Pro Slide. 10-24 x 5/8" long screws are supplied and are correct for 3/4" thick mounting surfaces, for surfaces thicker than 3/4", longer screws should be used, minimum 5 turns of thread engagement is

necessary. We do not recommend wood screws as this is a load bearing interface, mounting hardware substitutions are at the installers' discretion.

3) Mark all eight mounting holes and drill through cabinet floor; pilot drill first then drill up to 1/4".

4) The flat-head screw/furniture nut can install either direction; if an absolutely smooth surface is desired on the inside of the cabinet then countersink the holes slightly and install the screw from inside the cabinet, otherwise no countersink is necessary.

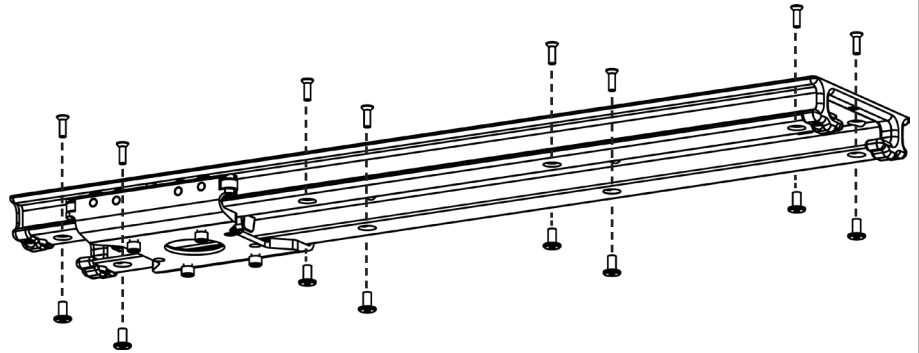

ATTACH ARM TO PRO SLIDE

Installation Video Time Stamp: 1:45

1) Remove the rear two socket head cap screws from the Pro Slide trolley and make sure the front two are only started into the trolley. Position the arm adapter plate against the trolley aligning the keyholes with the two cap screws previously started. Once engaged, slide back and install the two rear cap screws, tighten all 4 with the included 3/16" hex wrench.

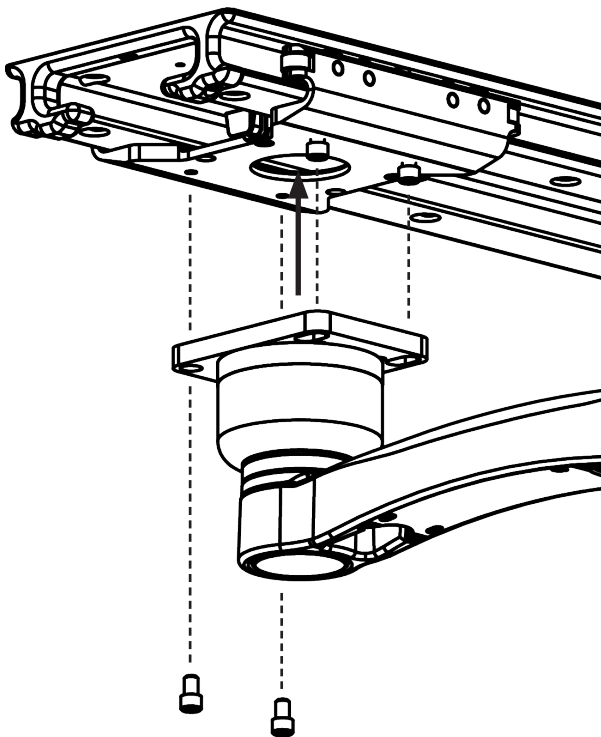

PRO SLIDE UNDERCABINET WORKSTATION INSTALLATION

UL500I Monitor Mount

▶ **MAXIMUM LOAD
CAPACITY: 18 LBS. (8.2 KG)**

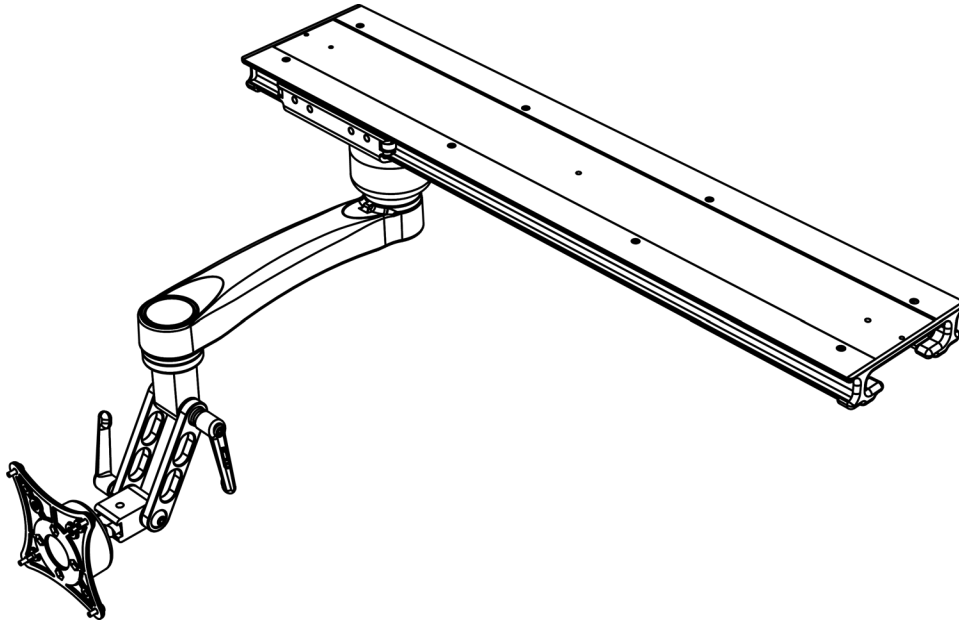

ATTACH MONITOR TO 500i

Attach ball VESA plate to monitor using the four 4mm screws in the hardware bag.

Remove beauty cap and screw from underside of Quick Disconnect.

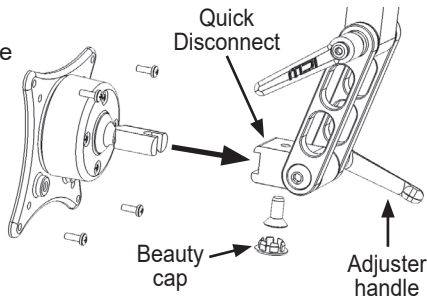

Slide VESA assembly into Quick Disconnect. Tighten screw with 5/16" hex key. Replace beauty cap.

Adjust monitor height and angle by loosening adjuster handles, moving monitor to desired position and tightening handles.

ADJUST VESA TENSION & ROTATION

Adjust pivot tension of the ball by gently and evenly tightening or loosening the four screws on the back of the ball VESA.

The ball VESA enables monitor to tilt, pan left and right and rotate.

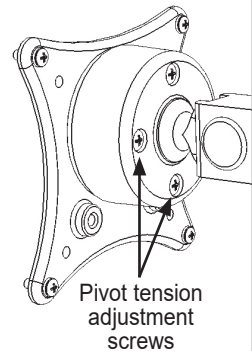

PRO SLIDE UNDERCABINET WORKSTATION INSTALLATION

UL550RAI Monitor Mount



ATTACH VESA TO MONITOR & RAILS

Attach VESA plate to monitor using the four 4mm screws in the hardware bag.

Screw slider knob through rails and into VESA assembly.

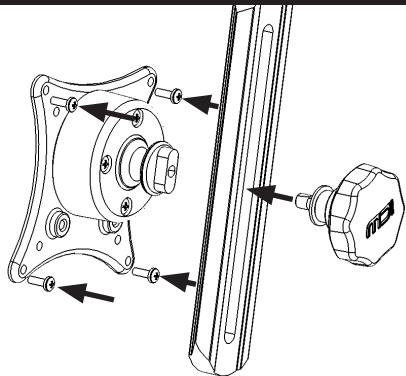

ADJUST BALL VESA HEIGHT & TENSION

To adjust monitor height, loosen slider knob, move monitor to desired height and tighten knob.

Adjust pivot tension of the ball by gently and evenly tightening or loosening the four screws on the back of the ball VESA.

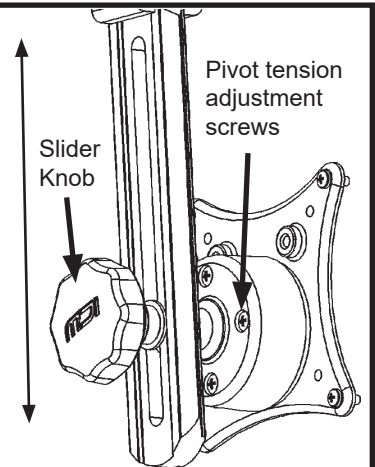

ADJUST MONITOR ON INVERTED ARM

Tilt monitor 50° in any direction and rotate to portrait or landscape by rotating ball VESA.

To adjust arm height, loosen Paralink adjustment knob, raise or lower arm and tighten knob.

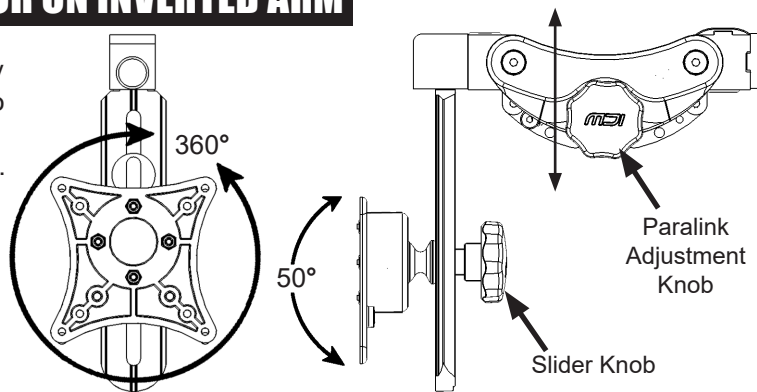

PRO SLIDE UNDERCABINET WORKSTATION INSTALLATION

UL560I Monitor Mount

ATTACH MONITOR TO 560i

Attach ball VESA plate to monitor using the four 4mm screws in the hardware bag.

Remove beauty cap and screw from top side of Quick Link. Slide VESA assembly into Quick Link. Replace screw and tighten with 5/16" hex key. Replace beauty cap.

Adjust monitor height and angle by pressing buttons on Quick Link. Move monitor to desired position and release buttons.

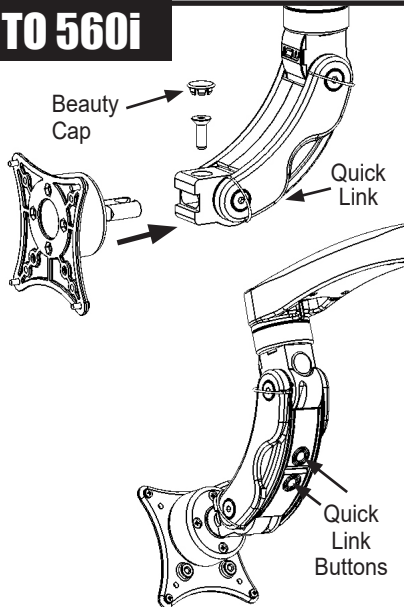

ADJUST VESA TENSION & ROTATION

Adjust pivot tension of the ball by gently and evenly tightening or loosening the four screws on the back of the ball VESA.

The ball VESA enables monitor to tilt, pan left and right and rotate.

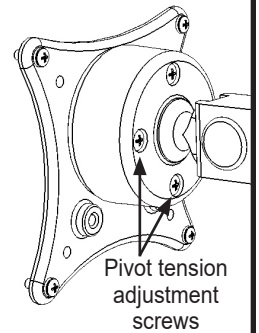

PRO SLIDE UNDERCABINET WORKSTATION INSTALLATION

UL180IBV / UL182IBV Monitor Mount

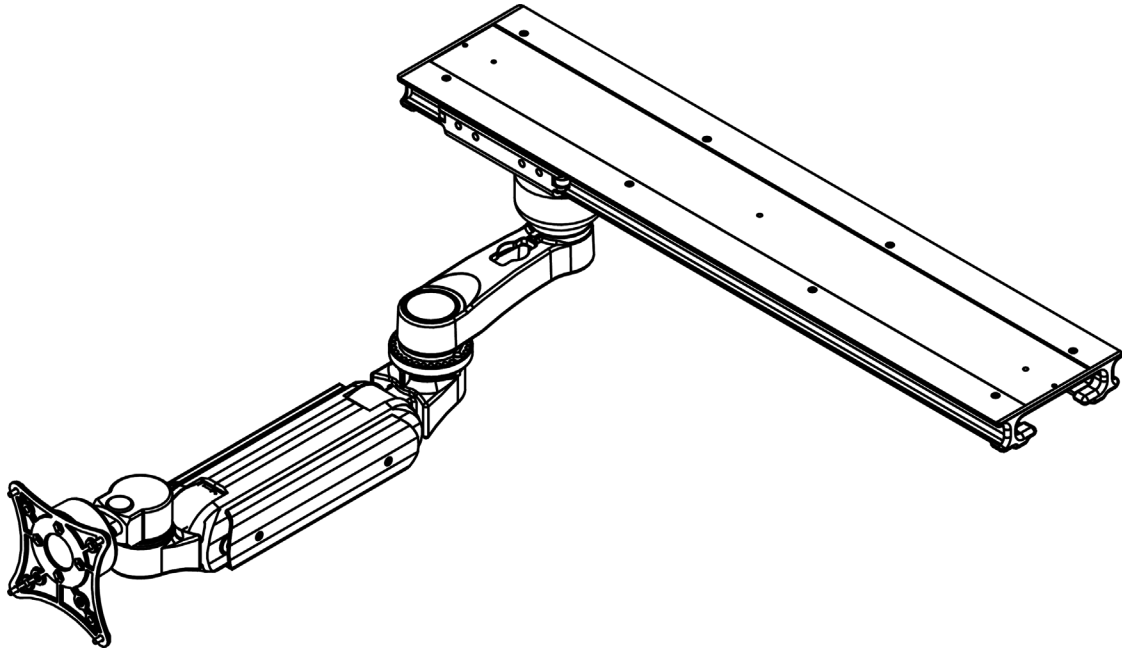

ATTACH VESA TO ULTRA ARM

- Remove beauty cap on Quick Disconnect block.
- Remove screw using 3/16" hex key.
- Slide VESA into Quick Disconnect block.
- Replace screw and tighten.
- Replace beauty cap.

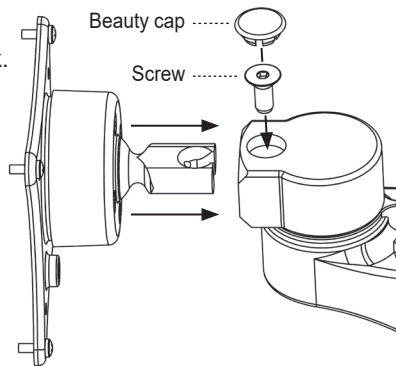

ATTACH VESA TO MONITOR

Attach VESA to monitor using a Phillips screwdriver and the four 4mm screws in hardware bag.

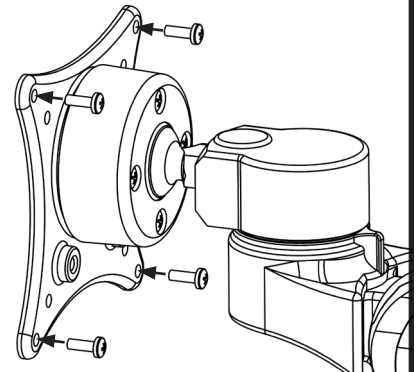

PRO SLIDE UNDERCABINET WORKSTATION INSTALLATION

UL180I / UL182I EV710 Monitor Mount with Keyboard

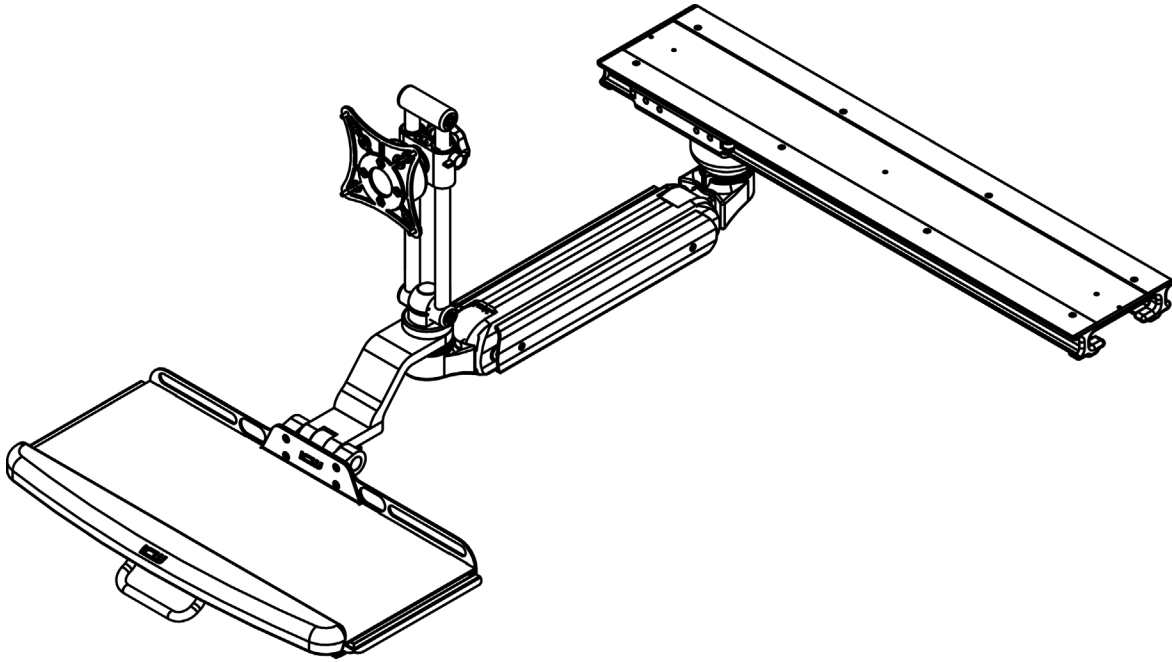

MOUNT WALL PLATE TO WALL

- Mount VESA assembly to slide rails.
- Fasten slider knob through rails and into VESA assembly.
- Attach VESA to monitor using four 4mm screws in the hardware bag

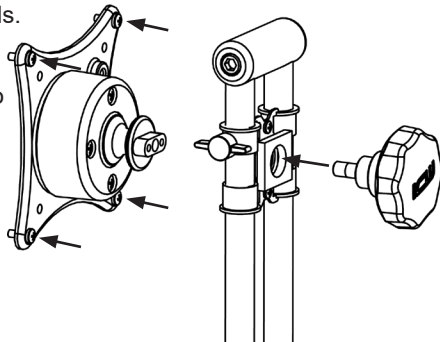

ADJUST BALL VESA HEIGHT & TENSION

- To adjust the height of monitor, loosen slider knob, position monitor height on slider rails then tighten knob.
- To adjust pivot tension, gently and evenly tighten or loosen the four screws on the back of the ball VESA.

Pivot tension adjustment screws

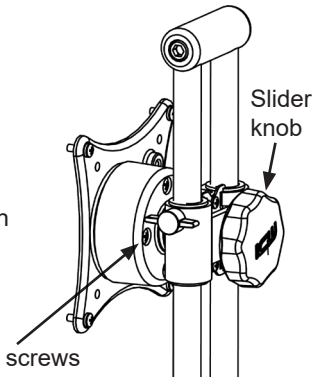

If Attaching To Ultra Flip-Up

ATTACH FLIP-UP TRAY

- Remove screws from drop extension using 5/32" hex key.
- Align holes in keyboard tray with screw holes in drop extension.
- Attach keyboard tray using the provided screws.
- If keyboard will not remain in vertical position, tighten the two button head screws underneath flip-up connector to adjust the flip-up's tension.

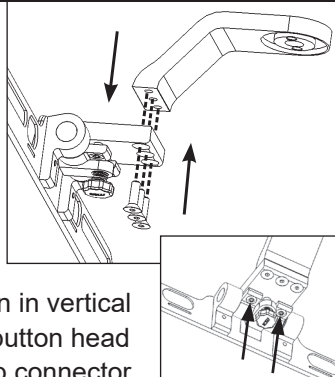

PRO SLIDE UNDERCABINET WORKSTATION INSTALLATION

Ultra Arm Cable Management

ULTRA CABLE MANAGEMENT

- Prepare all cables to route within the arm by placing them near cavity of arm and bundling together if necessary.
- Remove cover by unscrewing four Phillips head cap screws. Screws are captured by the cover so they cannot fall out. Once screws are disengaged, pull cover out of arm.
- Place cables within the channel. Do not block the holes where screws will engage in arm.
- Replace cover and tighten screws. Cables should be able to pull through to desired position if necessary.

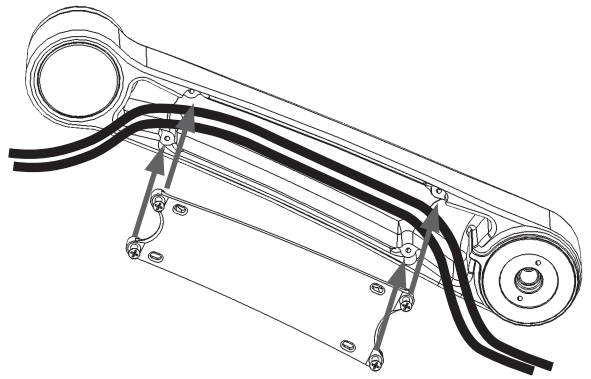

Ultra 180 Arm Cable Management

RUN CABLES THROUGH UL180 ARM

- Cover plate is spring loaded. Loosen cover plate screws on side of arm just enough to fit cables through gap.
- Run cables loosely between cover plate and arm. Cables can be run on either or both sides of the arm.
- Push cover plate against arm and tighten screws, being careful not to pinch cables.

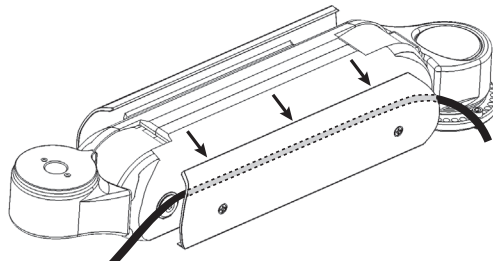

Adjusting Rotation Limits

ADJUST ROTATION LIMITS - UL180i UNDERCABINET

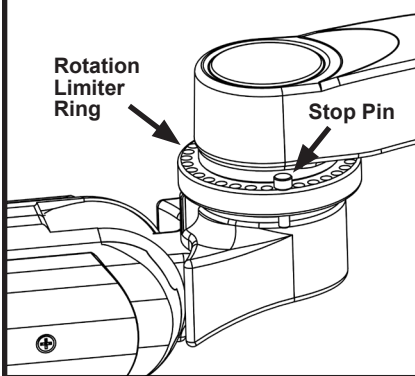

- Place stop pins in the holes of the rotation limiter ring where the arm should stop its horizontal rotation.
- The stop pin bumps the arm stop under the arm, stopping the arm's movement.
- The stop pins can be removed and repositioned by hand.

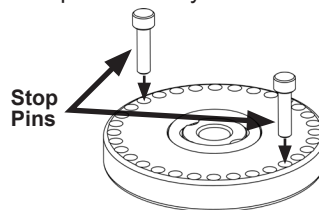
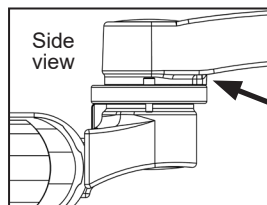

Adjusting Arm Tension

IMPORTANT

Extend the UL180 straight out and be sure all equipment is mounted on the arm before adjusting the arm's resistance. Use the T-handle provided to adjust the arm's resistance. Do not use power tools to adjust.

DO NOT ADJUST THE ARM TO SUPPORT MORE THAN 32 LBS. DOING SO MAY DAMAGE THE ARM.

ADJUST UL180 ARM TENSION

Using the 3/16" T-handle hex wrench provided, turn the screw in the UL180 arm clockwise to lighten the arm's load resistance, or counter-clockwise to increase the load resistance.

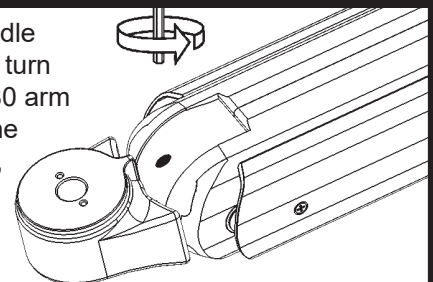

PRO SLIDE UNDERCABINET WORKSTATION INSTALLATION

ATTACH KEYBOARD TO DROP POLE

Installation Video Time Stamp: 2:45

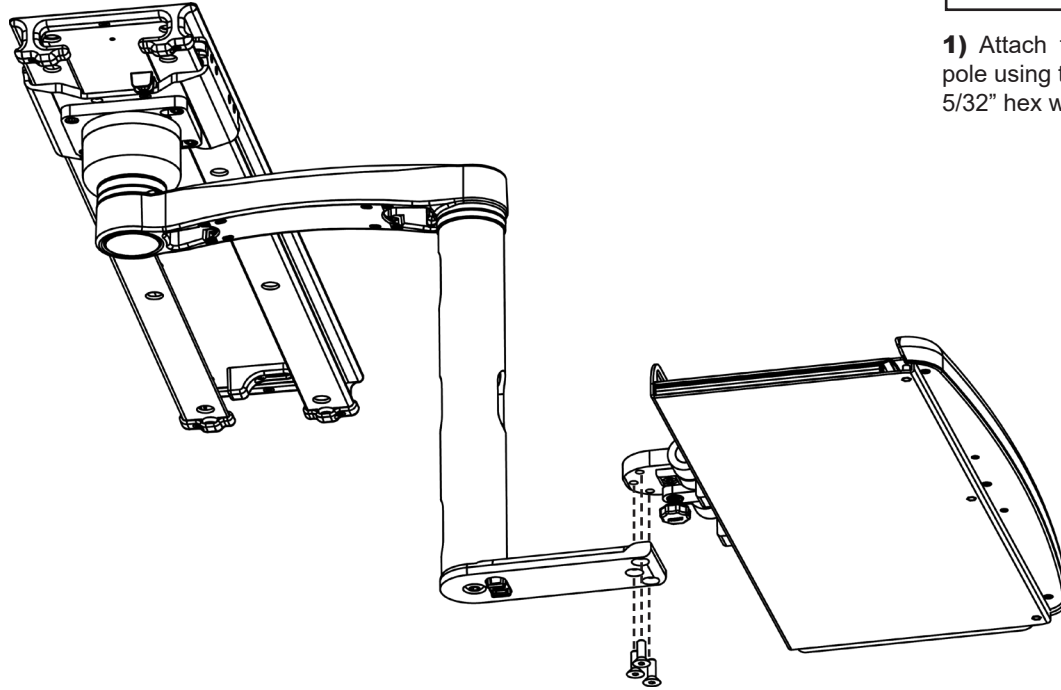

- 1) Attach the keyboard tray to the drop pole using three flat head cap screws and 5/32" hex wrench.

ATTACH MONITOR AND BALL VESA TO DROP POLE

Installation Video Time Stamp: 3:40

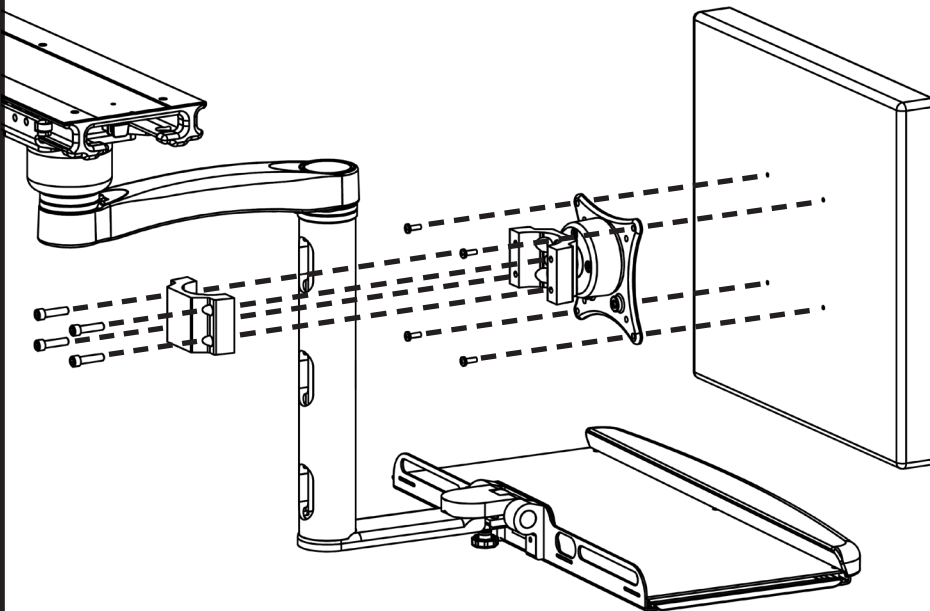

- 1) Attach the ball VESA monitor mount to the monitor using the four M4 VESA screws found in the hardware bag.
- 2) Attach this assembly to the upper end of the drop pole using a 3/16" hex wrench. Make sure to leave enough space for the largest cable end to pass through the upper opening in the drop pole.

PRO SLIDE UNDERCABINET WORKSTATION INSTALLATION

INSTALL MONITOR AND KEYBOARD WIRES THROUGH DROP POLE AND ARM

NOTE: Minimum 10-foot cables are required for proper cabling through track, arm, and drop pole. USB extension connections should be made ahead of the Pro Slide for proper cable travel in track.

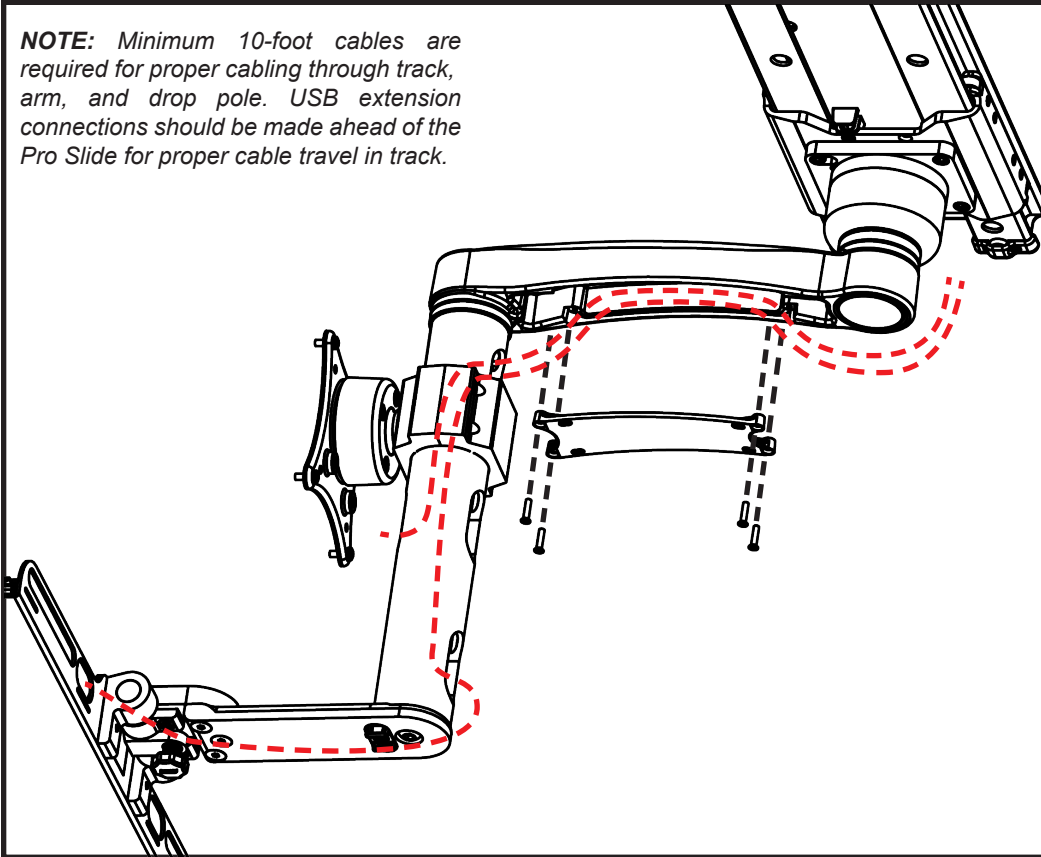

Installation Video
Time Stamp: 4:55

1) Drop the monitor end of the monitor cabling through the drop pole (in the upper slot and out the front center slot) and connect the monitor.

2) Route the keyboard/mouse USB cables under the keyboard mounting foot and up through the drop pole.

Installation Video
Time Stamp: 7:35

3) Pass all cables through the horizontal extension arm via removable arm cover.

PRO SLIDE UNDERCABINET WORKSTATION INSTALLATION

INSTALL MONITOR AND KEYBOARD WIRES IN PRO SLIDE

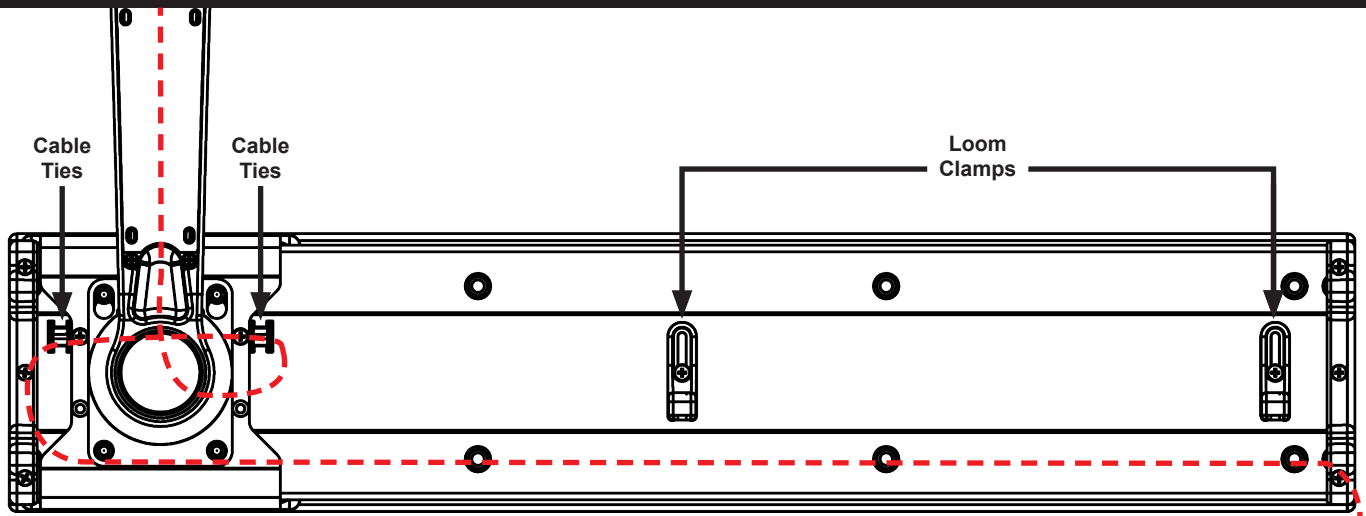

Installation Video Time Stamp: 8:35

- 1)** Feed the split loom over the cables making sure that the cables are free and not tangled inside the loom.
- 2)** The trolley/arm should be slid to the end of the track opposite to where the cables will pass into the cabinet. Loop the cables under the trolley, the cables/loom should cross the track at or just outside of the track end cap. Use cable ties to attach the cables/loom to the cable tie blocks on the trolley.
- 3)** Push the cable/loom clamps against the cable/loom in the center and left end and tighten in place.
- 4)** Travel the trolley/arm left to right several times to check for full travel and to ensure no cable binding or rubbing at any travel/pivot point.

CLEANING OF THE ICW MOUNTING DEVICE

When cleaning your ICW mounting unit please follow the points below. Proper cleaning of the mounting device will help assure proper function and extend the life of the unit.

1. Any general cleaner is acceptable except degreasers are not recommended near the bearing entrances.
2. Spray cleaner or water on a soft cloth or paper towel and then wipe down the mounts.
3. Do not spray directly at the bearing seams (located at all swivel points) as this could reduce the life of the bearings.

NOTICE: ICWUSA.COM, Inc. provides the appropriate hardware fasteners to match the majority if not all standard monitors and devices. It is the responsibility of the installer / integrator to ensure that the screws and fasteners have the adequate thread engagement. The rule of thumb is that the thread depth is greater than the diameter of the hole or 4 full turns of 360 degrees of thread engagement. It is also the responsibility of the installer / integrator to ensure that they do not damage the monitor or device by using a screw or fastener that is too long for hole and therefore damaging the unit by inserting too far.