

ICW SERVICE TRAY RETROFIT

ICWUSA.com, Inc.

If you have any questions please call Toll Free 1-800-558-4435

If Mounting Service Tray to an Elite Arm

MOUNT SERVICE TRAY

- Remove 3/8 - 16 x 2-1/4" socket head cap screw from the foot of the arm.
- Insert Service Tray mounting plate between keyboard drop and monitor mount. Make sure each bearing assembly is seated in its recessed groove.
- Replace socket head cap screw with the supplied 3/8 - 16 x 2-3/4" socket head cap screw. Tighten firmly.

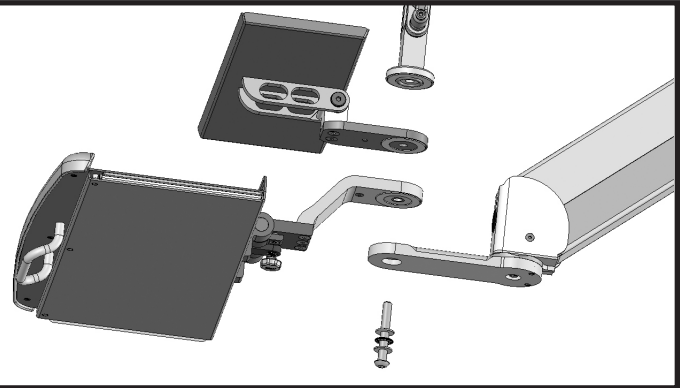

If Mounting Service Tray to an Ultra 180 or 182 Arm

REMOVE 710 SLIDER ASSEMBLY

Remove the 5/16 - 18 x 3/4" socket head cap screws from both sides of the EV710 base assembly. Lift 710 off slider assembly.

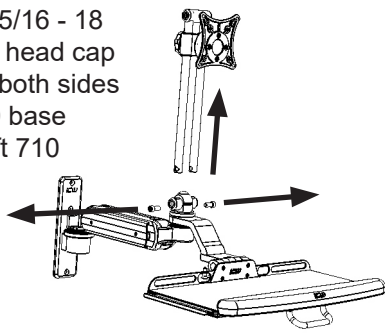

REMOVE CARRIAGE BOLT

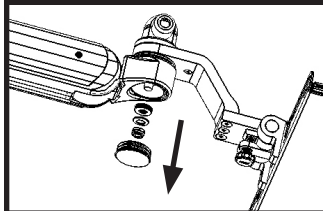

Remove beauty cap under the Ultra 180 arm. Remove jam nylock nut, Belleville washer, and bearing.

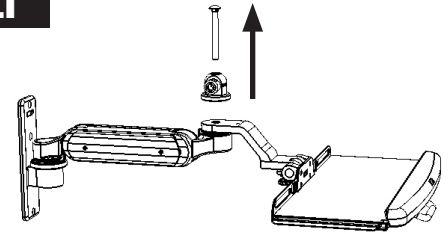

Remove 3/8 - 16 x 3-3/4" carriage bolt from EV710 base assembly.

MOUNT SERVICE TRAY

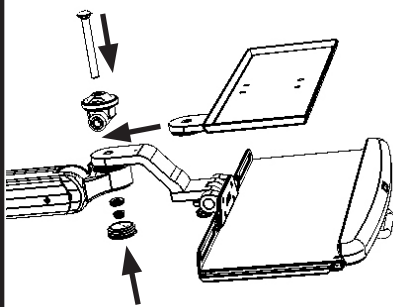

Insert Service Tray mounting plate between keyboard drop and EV710 base assembly.

Reassemble using supplied 3/8 - 16 x 4" carriage bolt, jam nylock nut, and bearing. Belleville washer will not be used. Tighten firmly. Replace beauty cap.

MOUNT 710 SLIDER ASSEMBLY

Insert 710 slider assembly into EV710 base assembly. Insert 5/16 - 18 x 3/4" socket head cap screws. Tighten firmly.

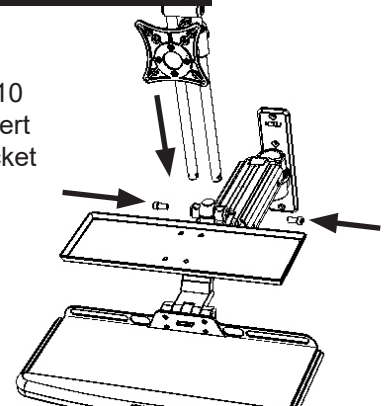

CLEANING OF THE ICW MOUNTING DEVICE

- When cleaning your ICW mounting unit please follow the points below. Proper cleaning of the mounting device will help assure proper function and extend the life of the unit.
1. Any general cleaner is acceptable except degreasers are not recommended near the bearing entrances.
 2. Spray cleaner or water on a soft cloth or paper towel and then wipe down the mounts.
 3. Do not spray directly at the bearing seams (located at all swivel points) as this could reduce the life of the bearings.

NOTICE: ICWUSA.COM, Inc. provides the appropriate hardware fasteners to match the majority if not all standard monitors and devices. It is the responsibility of the installer / integrator to ensure that the screws and fasteners have the adequate thread engagement. The rule of thumb is that the thread depth is greater than the diameter of the hole or 4 full turns of 360 degrees of thread engagement. It is also the responsibility of the installer / integrator to ensure that they do not damage the monitor or device by using a screw or fastener that is too long for hole and therefore damaging the unit by inserting too far.